

TRIPLE-ACTION HANDLE ASSEMBLY INSTRUCTIONS

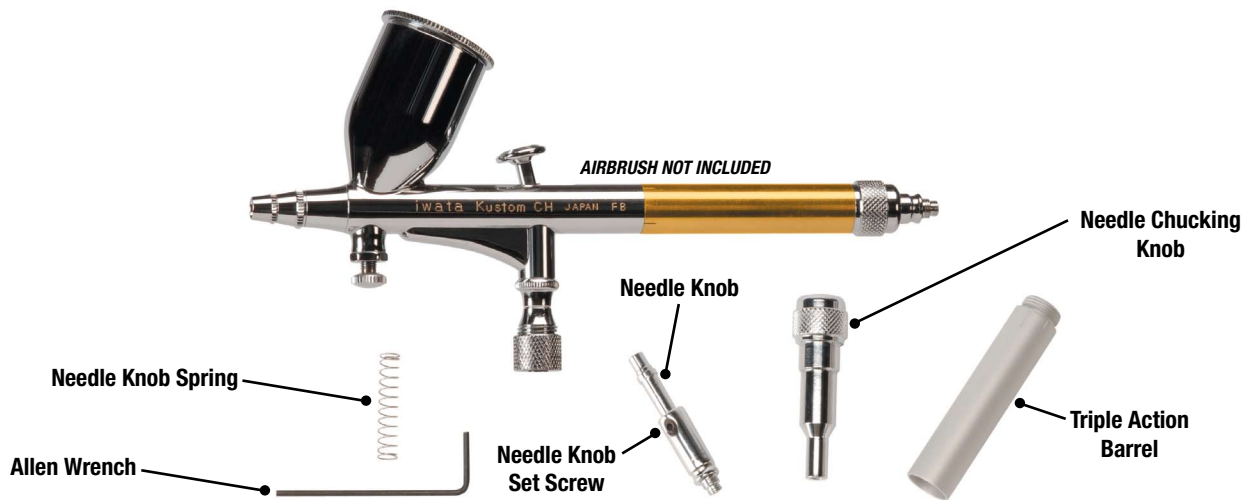

1. Remove handle. (image 1)

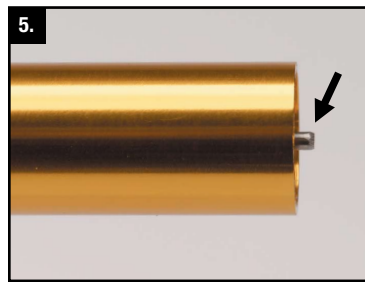

5. The needle should extend just past the end of the handle. (image 5)



2. Remove needle chucking nut. (image 2)

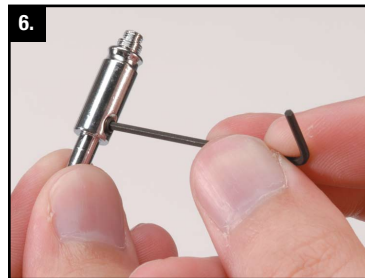

6. Place the Allen wrench into the set screw in the side of the Needle Knob. (image 6)



3. GENTLY push on the back of the needle to make sure it is seated into the nozzle. (image 3)

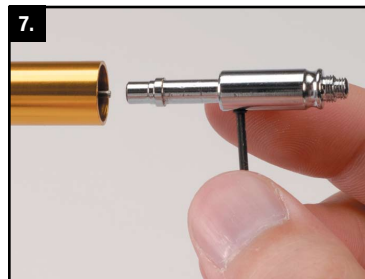

7. Slide the Needle Knob over the needle in the airbrush. (image 7)



4. Screw the Triple Action Barrel onto the airbrush body. Tighten lightly. (image 4)

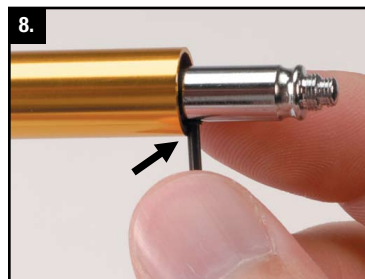

8. Slide the Needle Knob over the needle until the side of the Allen wrench comes into contact with the end of the Triple-Action Barrel. (image 8) **Note: If the Allen wrench cannot touch the end of the Triple-Action Barrel, unscrew the set screw one turn to allow the Needle Knob to move forward and seat properly.**

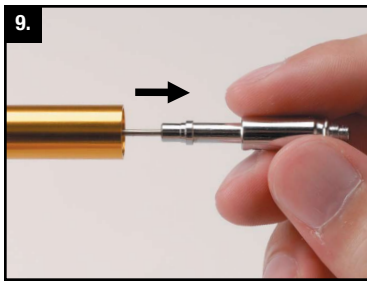

9. Firmly tighten the set screw by turning the Allen wrench. Take care not to bend the needle inside. The Needle Knob is now attached to the needle in the correct position.

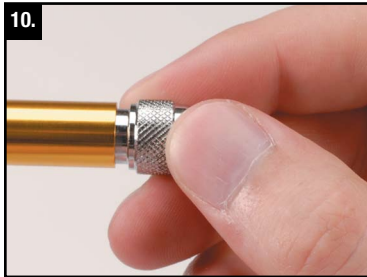

10. Pull the Needle Knob with the attached needle out the back of the airbrush. (image 9)

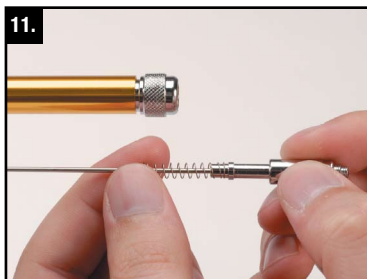

11. With the Needle Knob assembly removed from the airbrush, slide the Needle Chucking Knob into the back of the handle and screw it onto the needle chucking guide inside the handle. Screw it on until there is a small amount of resistance, but not all the way down to the handle. Then unscrew one full turn to unlock. (image 10)

12. Place the Needle Knob Spring over the front of the needle and slide it down the needle until it seats onto the front of the Needle Knob. (image 11)

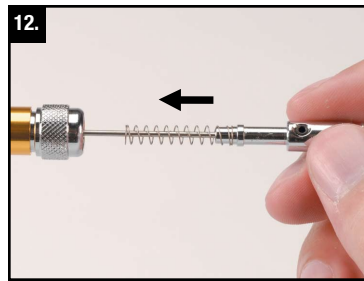

13. Slide the Needle Knob assembly into the back of the airbrush and gently push it forward until the needle is seated into the airbrush. (image 12) If you meet resistance, then unscrew Needle Chucking Knob a 1/2 turn further. Be careful when the tip of the needle passes through the main lever (trigger) area. If the needle stops abruptly, re-examine the main lever area to make sure it is assembled correctly.

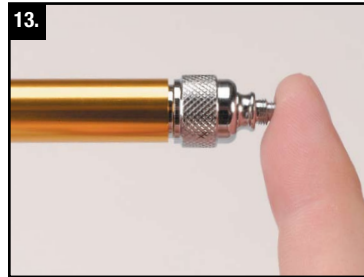

14. Gently push the back of the Needle Knob to seat it into the nozzle. (image 13) While gently pushing on the Needle Knob, use your thumb and middle finger to tighten the Needle Chucking Knob. (image 14)

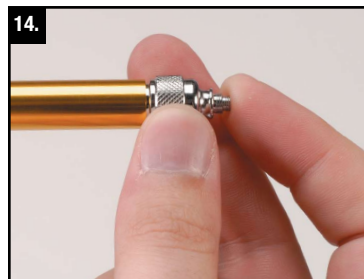

The Triple-Action Handle is now fully assembled!!!

TRIPLE-ACTION HANDLE HOW TO USE

Quick Needle Release

Unscrew the Needle Chucking Knob 1/4 turn. Pull the Needle Knob Assembly out the back of the handle. (image A)

Quick Needle Assembly

See steps 13 and 14.

Quick Flush

Fully open the nozzle by pulling back on the Needle Chucking Knob while spraying. This flushes out most clogs easily. It also allows the user to spray quick background areas. (image B)

Pre-Set Handle

Turn the Triple-Action Barrel to push back the Needle Knob while spraying. This pre-sets the spray pattern, operation becomes similar to a single action airbrush, for repeated spray use. (image C)

BONUS – Needle Cap Holder

Unscrew the needle cap and screw it onto the back of the Needle Knob. This provides a convenient place to store the needle cap when not in use. (image D and E)



Trouble Shooting

1. Continuous spray when the main lever (trigger) is not pulled back:

- The needle is not seated properly in the nozzle. Reseat the needle by unscrewing the Needle Chucking Knob to release the needle and gently pushing on the back of the Needle Knob while retightening the Needle Chucking Knob.
- The Triple-Action Barrel is being used as a Pre-Set handle and not allowing the nozzle to fully close. Turn the Triple-Action Barrel until it is tight on the airbrush body.
- The Needle Knob is not positioned correctly on the needle. Repeat steps 3 - 8.

2. The Needle Knob does not spring back when loosening the Needle Chucking Knob:

- The needle spring is not on the Needle Knob Assembly.
- Dried paint is causing too much friction inside the airbrush. Use Iwata-Medea SUPERLUBE to lubricate the main lever (trigger) area.

3. The Needle Knob does not attach to the needle when tightening the set screw:

- The Triple-Action Barrel is not screwed all the way onto the airbrush body before attaching the Needle Knob. Repeat Steps 3 - 8.
- The Needle Knob's set screw is too tight before positioning it onto the needle. Loosen the set screw and repeat step 3 - 8.
- The nozzle is damaged allowing the needle to move too far forward in the airbrush. Inspect nozzle and replace if necessary.

iwata
MEDEA

P.O. Box 14397, Portland, OR 97293
tel: 503-253-7308 fax: 503-253-0721
www.iwata-medea.com info@medea-artool.com